

Wired 3/19/2019

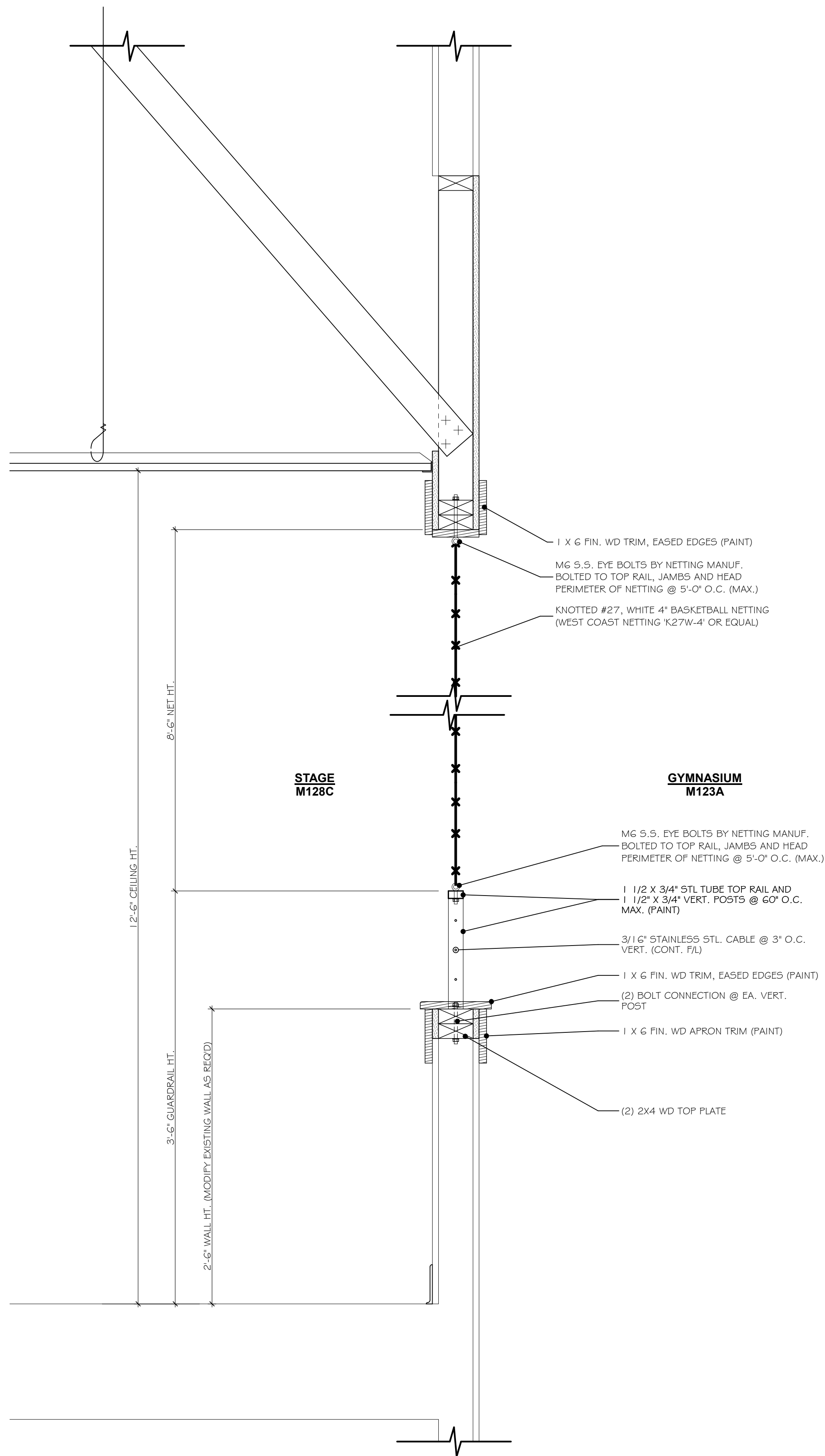

SECTION @ WEST STAGE WALL
SCALE: 1 1/2" = 1'-0"

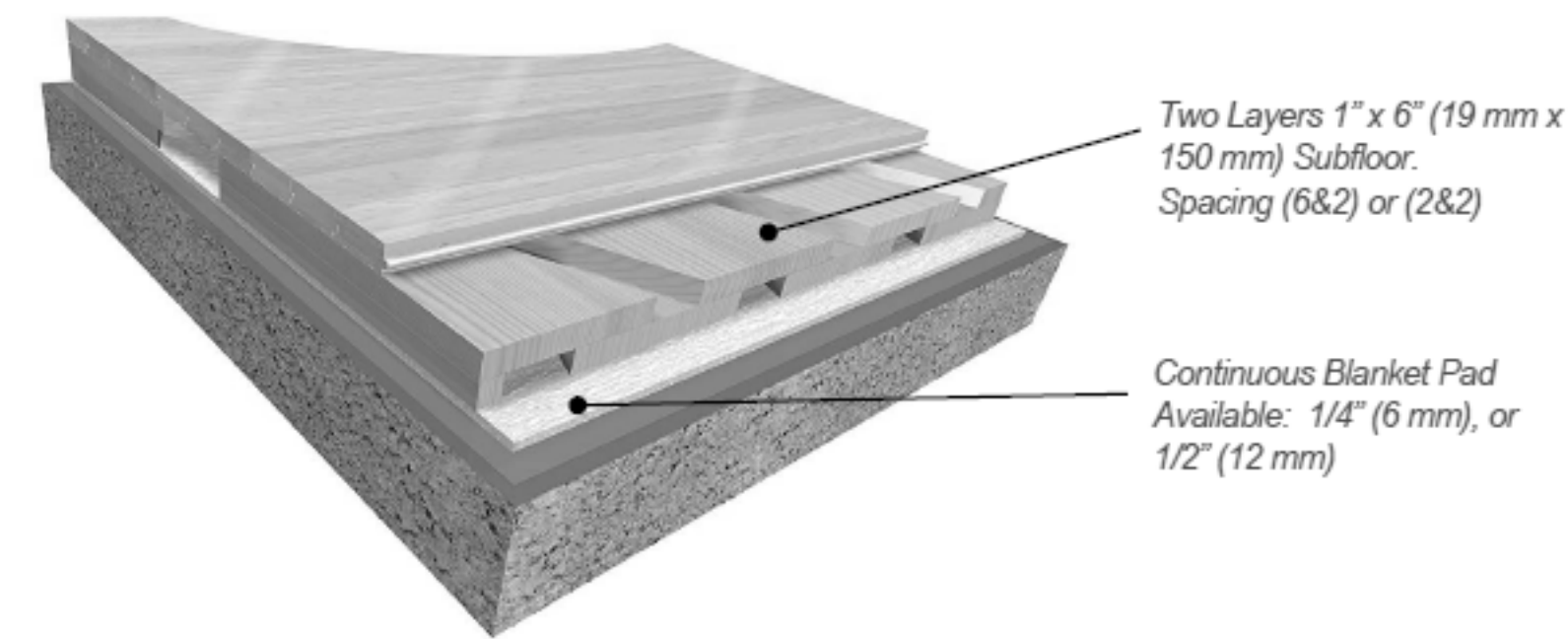

| | |
|--|---|
| MFMA NORTHERN HARD MAPLE BY ACTION: | Random Length (RL) Action Long Length (FJ) Expansion Ridge Technology (ERT) |
| TESTING AGENCY: | Certified by ISSS |
| PERFORMANCE MEETS OR EXCEEDS: | ASTM - F2772 |
| SLAB DEPRESSION 1/4" (6 mm) PAD: | 25/32" (20 mm): 2-1/2" (64 mm) 33/32" (27 mm): 2-3/4" (70 mm) |

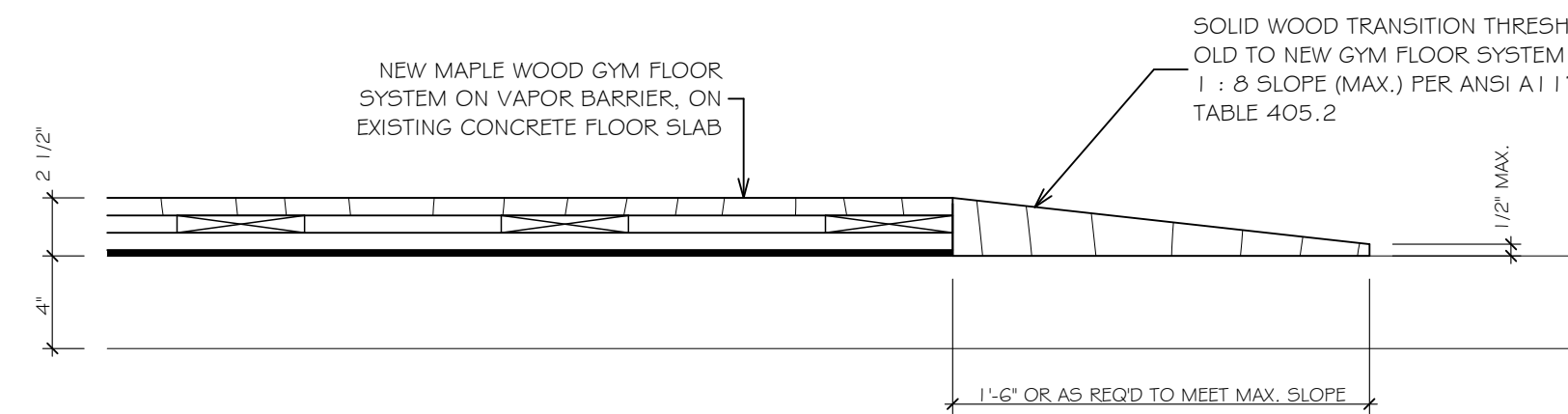

NOTE:
DESIGN BASED ON ACTION FLOOR SYSTEMS 'ACTION INTERLOC I FLOOR SYSTEM' FLOATING MAPLE SPORTS FLOOR W/ 1/4" CONT. FOAM PAD. (OR APPROVED EQUAL)

GYM FLOOR DETAIL
NOT TO SCALE

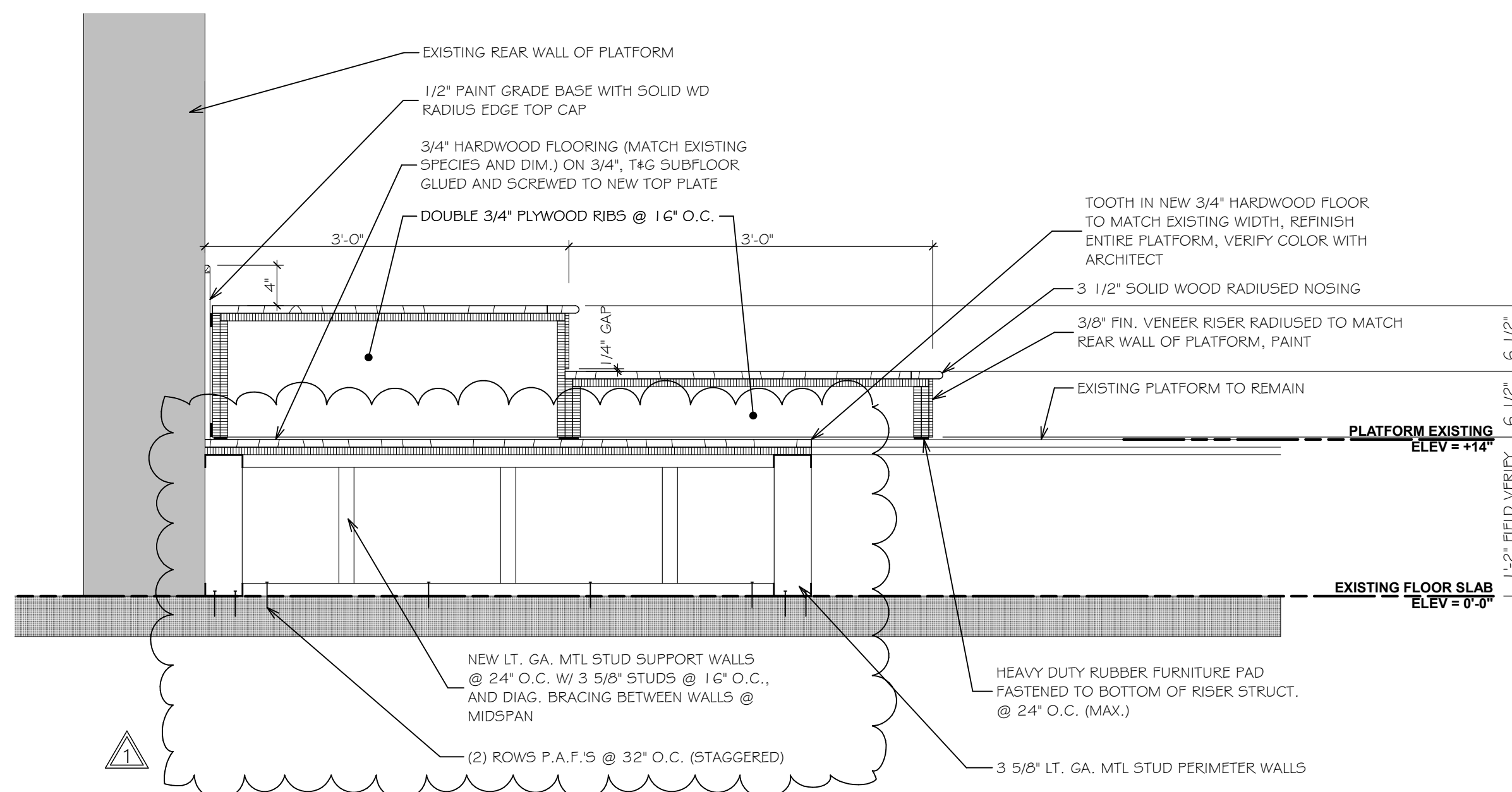

DETAIL AT PLATFORM S104C
SCALE: 1" = 1'-0"

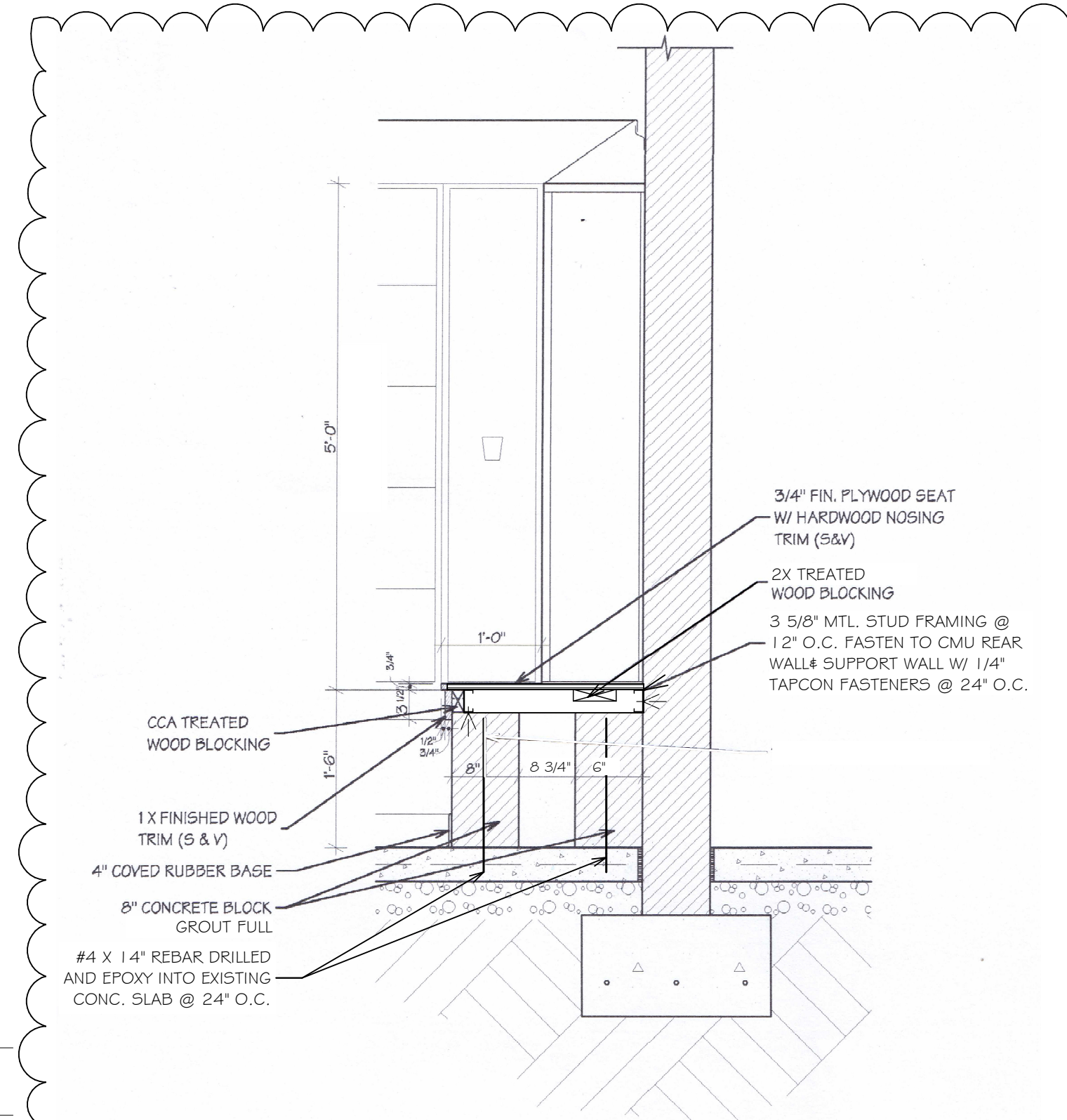

NOTE:
METAL LOCKERS SHALL BE DOUBLE TIER CONFIGURATION WITH POWDER COATED FINISH OF MANUF. STANDARD COLORS W/ COLOR T.B.D. (REPUBLIC STORAGE SYSTEMS 'SINGLE POINT II' OR EQUAL) CONTRACTOR SHALL SUBMIT SHOP DRAWINGS FOR REVIEW AND APPROVAL BY OWNER/ARCHITECT.

ATHLETIC LOCKER BASE
NOT TO SCALE

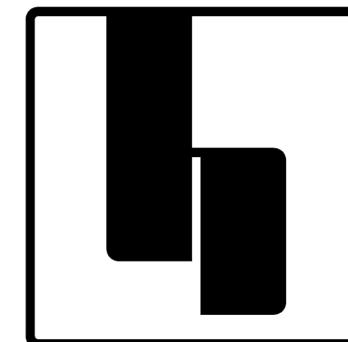

hostetlerarchitecture
■ ARCHITECTURE ■ PLANNING
3967 MARKET STREET
WILMINGTON, NC 28403
PHONE: 910.612.1119
www.hostetlerarchitecture.com

CONSULTANTS

RENOVATIONS TO

**GRACE
BAPTIST
CHURCH**

WILMINGTON
NORTH CAROLINA

HOSTETLER ARCHITECTURE
STATE REGISTRATION



ARCHITECT OF RECORD
SHAWN E. HOSTETLER
11926

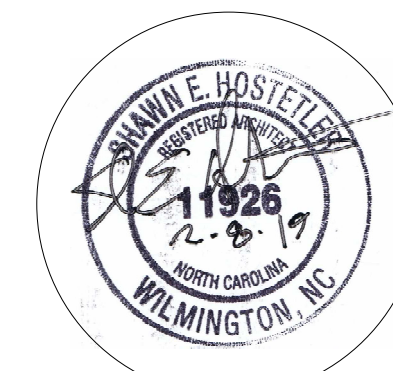

CONSTRUCTION DOCUMENTS : 02.08.19

| REVISIONS | | |
|---------------|----------|---------------------------|
| MARK | DATE | DESCRIPTION |
| 1 | 03.19.19 | CONTRACTOR CLARIFICATIONS |
| 2 | | |
| 3 | | |
| 4 | | |
| DRAWN BY: | | PROJ. MGR: |
| SHEET CONTENT | | |

WALL SECTIONS, DETAILS

JOB NO.
18013

SHEET
A302

© 2018